



ABR-100U

Scalpel Blade Remover

Instructions for Use

MOUNTING TO WALL, BENCH OR TROLLEY:

Wall Mounting

Ensure bracket is firmly fixed to the wall. Seek professional help if necessary. Fasteners are not provided in the package as they vary depending on the type of wall.

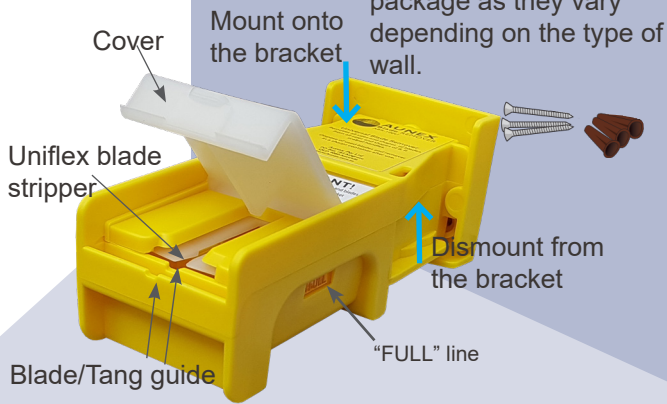

Bench Mounting

Lift to Open
Push to Close
Press to Lock

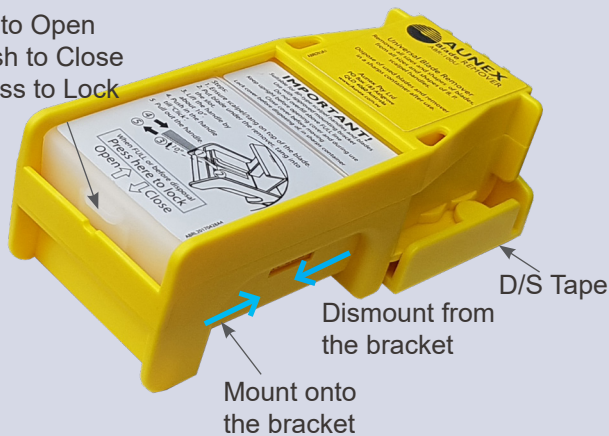

ABR100UINS01A2

REMOVE BLADE SINGLE HANDED ACTION:

Step 1:

- ABR-100 mounted on bracket.
- Check it is not overfilled.
- Lift cover.
- Ensure tang on top of blade.
- Put blade under the blade stripper.

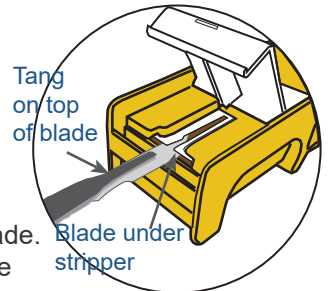

Step 2:

- Lifting up the handle by about 10°, push scalpel/blade into ABR-100.

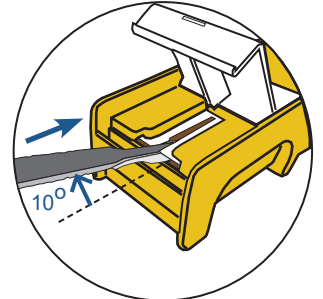

Step 3:

- Push till "Click" or stopped.

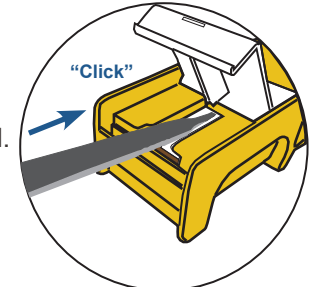

Step 4:

- Pull out the handle.
- Blade contained in ABR-100.
- Ensure no blade protruding from the slots.
- Close the cover.

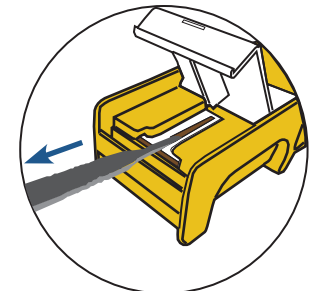

Disposal:

- Press to lock cover before moving.
- Dispose of used ABR-100 in a sharps container.

Aunex Pty Ltd
+614 0413 2553
aunex@aunex.com.au
www.aunex.com.au

